

58-95 Maurice Avenue
Maspeth, NY

LEASED BY:



Kurv Maspeth New York



Q2 2026

Available for Lease

38,536 SF

Available Interior Space

14,463 SF

Available Exterior Space

KURVINDUSTRIAL.COM

Site Plan

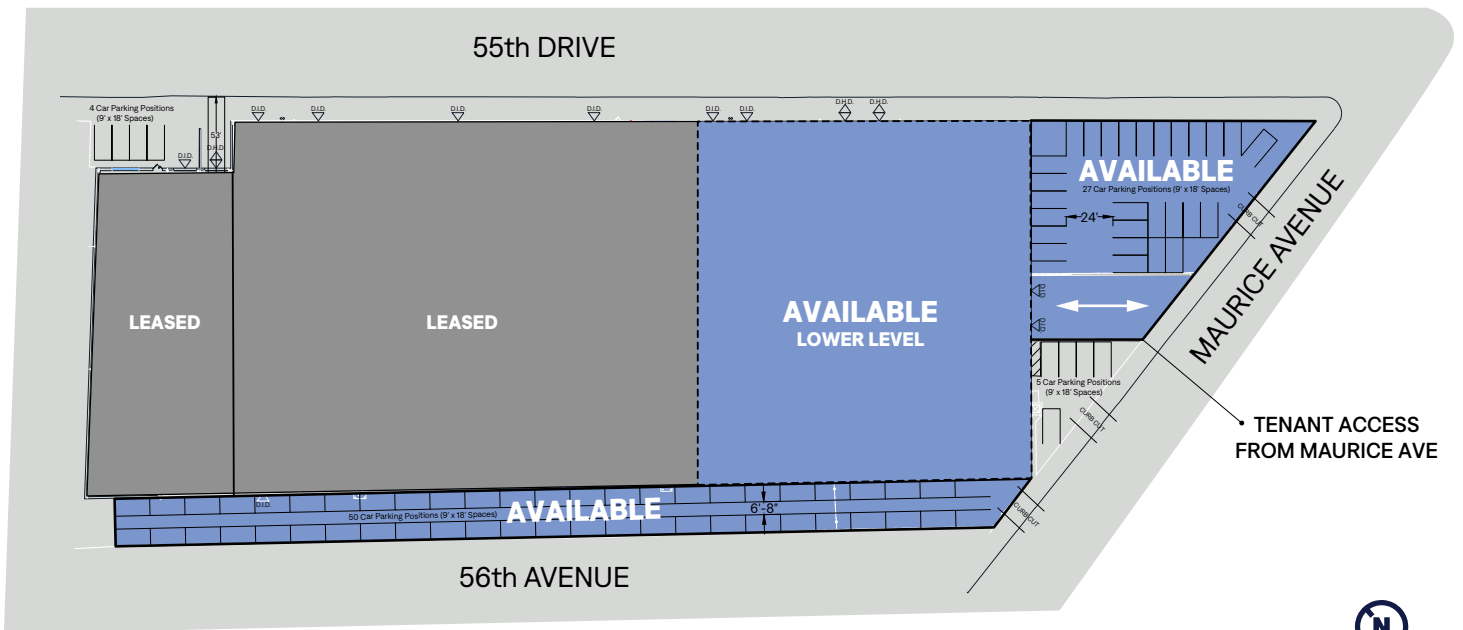

AVAILABLE LOWER LEVEL SPACE WITH CARS

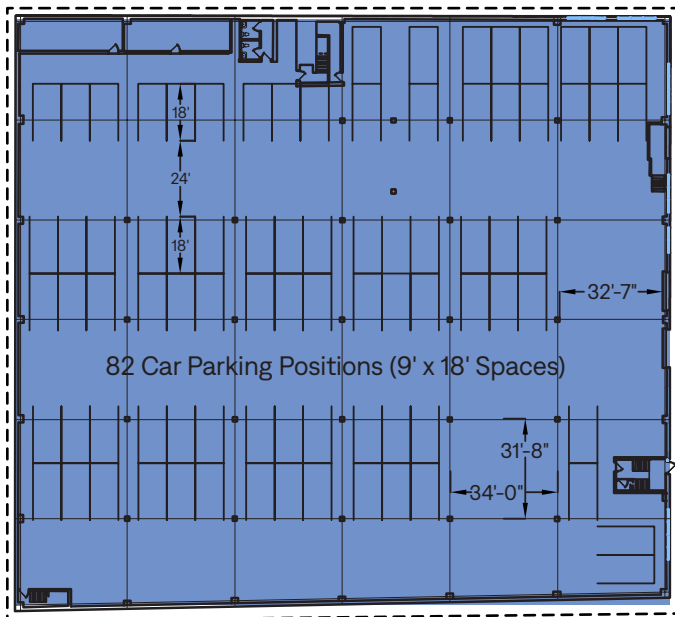

AVAILABLE LOWER LEVEL SPACE WITHOUT CARS

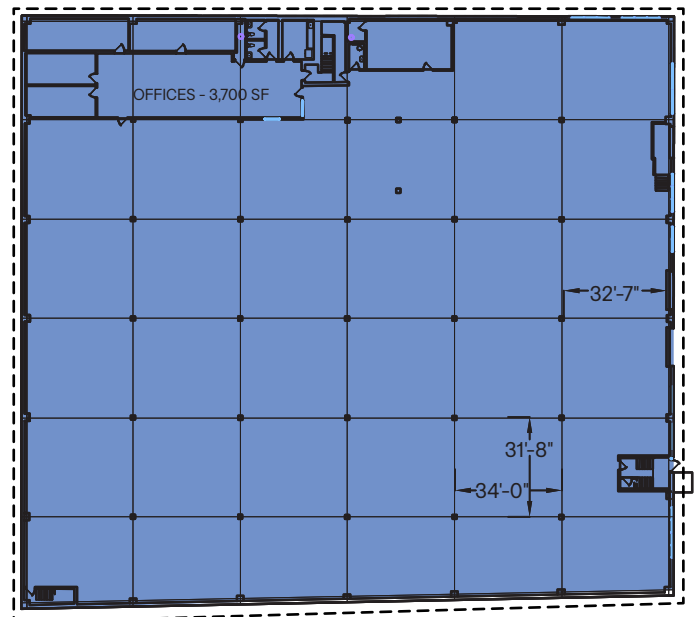

Building Specs

ADDRESS

58-95 Maurice Avenue,
Maspeth, NY

TOTAL INTERIOR AREA

38,536 SF

TOTAL EXTERIOR AREA

14,463 SF

CLEAR HEIGHT

21'

DRIVE-IN DOORS

2 (10' x 14')

OFFICE

3,700 SF

DEDICATED PARKING

109 spaces
(with cars configuration)

POWER

Proportional allocation
(~277 amps)



LOCALITY

Location and Demographics

Located in the Central Queens Submarket, Kurv Maspeth offers immediate access to 495 (0.2 miles) and 278 (1.2 miles) as well as an abundance of local amenities.

Q39 BUS STOP

0.2 miles

LAGUARDIA AIRPORT

4.6 miles

BROOKLYN BRIDGE

6.0 miles

LONG ISLAND CITY, QUEENS

2.4 miles

MIDTOWN MANHATTAN

5.0 miles

JFK AIRPORT

8.9 miles

WILLIAMSBURG BRIDGE

4.4 miles

DOWNTOWN MANHATTAN

5.6 miles

GEORGE WASHINGTON BRIDGE

11.7 miles



LOCALITY



ACCESSIBILITY



DRIVE TIME
1.3 MILES / 5 MINS - 278

DRIVE TIME
0.1 MILES / 1 MIN - 495

LOCATION

DEMOGRAPHIC INFORMATION	10 MILES	20 MILES	30 MILES
Total Population	8,117,174	13,001,355	15,946,809
Total Warehouse/Transportation Workers	98,580	184,625	224,730
Median HH Income	\$79,949	\$83,534	\$90,787

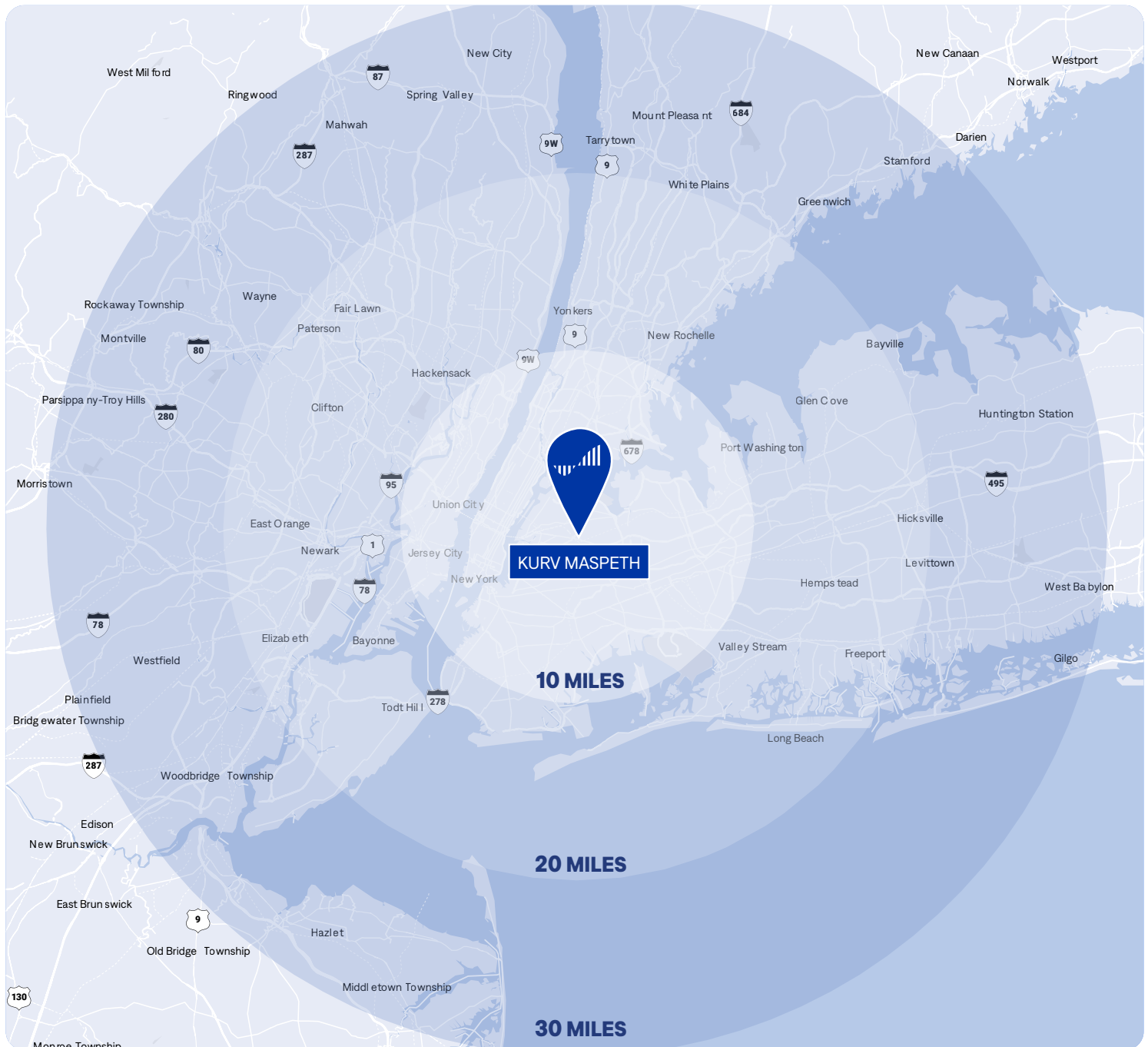

Chicago • Dallas • Los Angeles • Miami • New Jersey • Seattle



76M+SF

Acquired & Developed
since 2000

Kurv Industrial is a vertically integrated industrial real estate investment and operating platform. The firm acquires, develops, and operates institutional-quality assets in the high-barrier, supply-constrained markets of Chicago, Dallas, Miami, Los Angeles, New Jersey, and Seattle.

Grounded in a tradition of excellence and driven by a forward-looking vision, Kurv leverages local market insight, operational rigor, and disciplined execution to create value for investors, partners, and communities. Since its inception in 2000, Kurv has successfully acquired and developed over 76 million square feet of industrial facilities.

Our Commitment to Sustainability

As stewards of sustainability, resilience, and regeneration, our vision is to deliver exceptional value for our investors, employees, tenants, and communities through superior ESG performance.



TERMS

Available on a new lease direct from the landlord.



KURVINDUSTRIAL.COM

58-95 Maurice Ave, Maspeth, NY

LEASING INFORMATION

Please contact listing agents below.



Leslie Lanne
leslie.lanne@jll.com
+1 212 292 7597

Jeremy Liebler
jeremy.liebler@jll.com
+1 212 376 4346

For over 200 years, JLL (NYSE: JLL), a leading global commercial real estate and investment management company, has helped clients buy, build, occupy, manage and invest in a variety of commercial, industrial, hotel, residential and retail properties. A Fortune 500® company with annual revenue of \$23.4 billion and operations in over 80 countries around the world, our more than 113,000 employees bring the power of a global platform combined with local expertise. Driven by our purpose to shape the future of real estate for a better world, we help our clients, people and communities SEE A BRIGHTER WAY. JLL is the brand name, and a registered trademark, of Jones Lang LaSalle Incorporated. For further information, visit jll.com.

For the joint agents and the vendors or lessors of this property whose agents they are, give notice that: 1) The particulars are set out as a general outline only for the guidance of intending purchasers or lessors and do not constitute, nor constitute part of, an offer or contract. 2) All descriptions, dimensions, references to condition and necessary permission for use and occupation, and other details, are given in good faith and are believed to be correct but any intending purchasers or tenants should not rely on them as statements or representations of fact but satisfy themselves by inspection or otherwise as to the correctness of each of them. 3) No person in the employment of the joint agents has any authority to make or give any representation or warranty whatever in relation to this property. October 2024. designed & produced by cormackadvertising.com

©2026 Jones Lang LaSalle Brokerage, Inc., a licensed real estate broker. All rights reserved.